



- 1/2.7" 4Megapixel progressive scan CMOS
- Day/Night(Electronic), WDR
- 2.8mm Fixed Pinhole Lens
- 8-meters cable
- Require a Main Box to work together



THC4IPPC3

4MP Covert Pinhole Network Camera-Lens Unit

Caratteristiche Funzionali

System Overview

THC4IPPC3 covert camera used modular design, this product provides an independent miniature sensor unit (with 8-meters cable), while there is a main unit for customers to choose. It can be easily installed into any indoor environments, which makes this camera ideal for the ATMs(Automatic Teller Machines), banks, stores, hotels and offices.

Camera

Image Sensor	1/2.7" 4Megapixel progressive scan CMOS
Scanning System	Progressive
Effective Pixels	1920(H)x1080(V)
Minimum Illumination	0.007Lux/F2.4 (Color,1/3s,30IRE) 0.08Lux/F2.4 (Color,1/30s,30IRE) 0.004Lux/F2.4 (B/W,1/3s,30IRE) 0.04Lux/F2.4 (B/W,1/30s,30IRE)
IR Distance	N/A
IR On/Off Control	N/A
IR LEDs	N/A

Lens

Lens Type	Fixed			
Mount Type	Board-in			
Focal Length	2.8mm			
Max. Aperture	F2.4			
Angle of View	H:83° ,V:45°			
Optical Zoom	N/A			
Focus Control	Fixed			
Close Focus Distance	0.5m			
DORI Distance	Detect	Observe	Recognize	Identify
	61m(200ft)	24m(80ft)	12m(40ft)	6m(20ft)

Pan/Tilt/Rotation

Pan/Tilt/Rotation Range	N/A
-------------------------	-----

Certification

Certifications	CE (EN 60950:2000) UL:UL60950-1 FCC: FCC Part 15 Subpart B
----------------	--

Environmental

Operating Conditions	-30° C ~ +60° C (-22° F ~ +140° F) / Less than 95% RH
Storage Conditions	-30° C ~ +60° C (-22° F ~ +140° F) / Less than 95% RH
Ingress Protection	N/A
Vandal Resistance	N/A

Construction

Casing	Metal
Dimensions	30mm×31mm×29.3mm(1.18"×1.22"×1.15")
Net Weight	0.40Kg (0.88lb)
Gross Weight	0.47Kg (1.03lb)

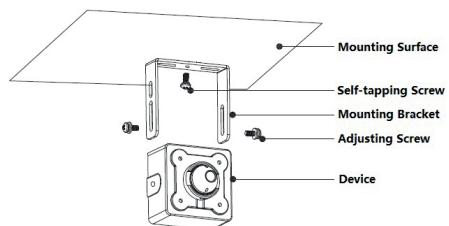
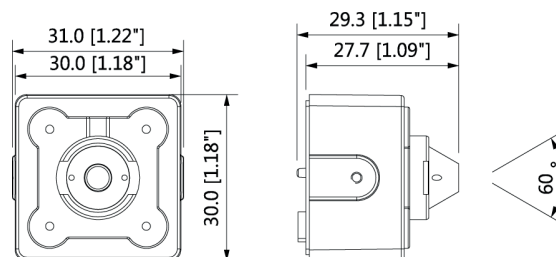
Installation**Dimension****Hiltron Land S.r.l.**

Strada Provinciale di Caserta, 218 80144 - Napoli - Italy
Tel: (+39) 081.185.39.000 Fax: (+39) 081.185.39.016
www.hiltronsecurity.it

